

EN Operating / Care instructions Changing table 334

1. Operating instructions

Height adjustable baby changing table.

- Press and hold the button to start the operation.
- Release the button when the changing table is at the desired level.

Pos. 1

Control button

Pos. 2

Comprehensive built-in safety switch

Pos. 3

Model without sink has a foldable nursing table area.

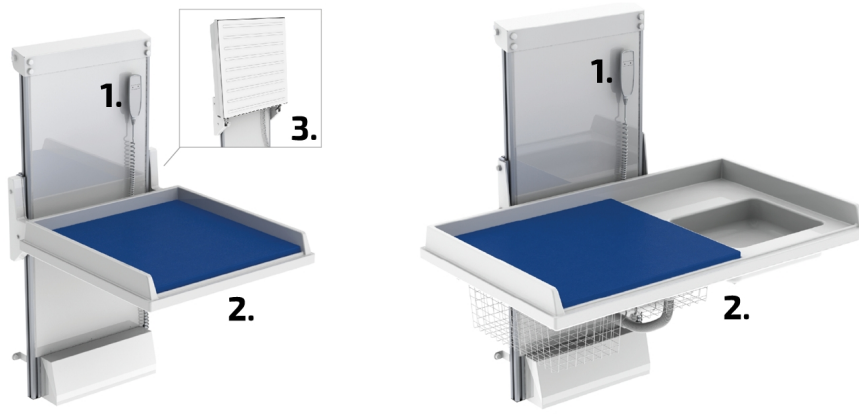

2. Maintenance

The changing table is maintenance-free. Greasing and other actions are made during the manufacturing for the lifetime of the lift. From safety point of view however some components shall be inspected each year.

- Inspections, service and repair work shall be made by competent persons.
- Remove any objects from the changing table before maintenance and repair works are made.

3. Functional test

- Make sure that the wall installation is intact.
- Run the changing table down and up all the way to respectively end position. Check that it moves freely, without hindrance and jarring sounds.
- Check that no cables are jammed.
- Check the function of safety switch:
Run down the changing table while lifting safety plate the underside of the table. Make sure that the lowering is stopped.
- Model with sink:
Run the changing table to the end position and make sure the hoses are long enough above the fixing point.

4. Cleaning

Clean with lukewarm water and a non-scratching detergent containing soap or similar. Use a soft cloth or similar. After cleaning the surfaces shall be dried to avoid lime deposits.

**Scratching detergents or tools e.g. steel wool may not be used.
Consider that the product contains electrical components.**

Cleaning the plastic surface - ABS plastic:

The surface is easy to keep clean. Use cleaning spirit to ensure hygiene. Do not use abrasive or corrosive cleaning agents, this might damage the finish.

5. Service & maintenance records

Order	Serial	Date
--------------	---------------	-------------

Date	Date
Sign	Sign
Remarks	Remarks

Date	Date
Sign	Sign
Remarks	Remarks